

# ULTIMATE DIY HOT TUB BUILDING GUIDE

UPDATED FOR 2025



<b>FOREWARD</b>	1
<b>STRUCTURE</b>	3
POURED FORM	4
CONCRETE BLOCK CAVITY	5
CMU BLOCK	7
ICF BLOCK	8
IN GROUND CAVITY	10
WHICH METHOD DO I OPT FOR?	11
THE FINISH	12
LAYING HOT TUB BASE	12
LAYING THE BASE FOR THE CONCRETE SLAB	14
GRAVEL BASE	14
WOOD FRAME & WATERPROOF MEMBRANE	15
METAL REBAR FOR YOUR HOT TUB SLAB	17
CEMENT MIXING	18
REMOVE THE WOODEN FRAME / MOULD	20
<b>INSULATION</b>	22
WHAT ABOUT TUBBLOX INSULATED CONCRETE FORMS?	23
DIY HOT TUB INSULATION FOR BLOCK BUILT HOT TUBS	24
HOW DO WE INSULATE A HOT TUB THAT IS BUILT OF BLOCKS?	24
DIY HOT TUB INSULATION FOR POURED CONCRETE FORMS	26
<b>WATERPROOFING YOUR HOT TUB STRUCTURE</b>	30
PREPARING THE SURFACE	31
BLOCK SURFACE PREPARATION	31
IN EUROPE FROM B&Q	32
IN THE USA	33
SEALING THE CONCRETE	34
NOW FOR THE WATER PROOFING LAYER	34
DO I NEED A SEPARATE GROUT AND ADHESIVE?	36
SEALING AROUND THE JET WALL NICHE, SKIMMER AND INWARD SUCTION	
DRAINS	37

<b>CONTROL ROOM</b>	40
CONTROL ROOM POSITION	41
ABOVE GROUND AND ABOVE THE WATER LEVEL	44
CONTROL ROOM PIPING	46
HOW TO BUILD THE ULTIMATE CONTROL ROOM FOR YOUR HOT TUB	48
HOW MUCH SPACE DO I NEED?	49
WHAT ARE THE COMPONENTS OF THE “CONTROL ROOM”	49
ASSEMBLY STEPS	52
CONNECTING UP THE CABLES	61
TOPSIDE CONTROLS	64
TESTING	64
<b>FLOW RATE CALCULATIONS</b>	66
<b>PLUMBING</b>	68
<b>ELECTRICAL RECOMMENDATION</b>	70
<b>HOW TO MAKE THE PERFECT PVC SOLVENT WELD JOINT</b>	72
HOT TUB PLUMBING	73
CUTTING THE PIPE	73
CLEANING THE PIPE	74
PRIMING THE PIPE	74
CLEANING THE FITTING FOR A PVC SOLVENT WELD JOINT	75
MARKING YOUR PIPE DEPTH	75
APPLYING SOLVENT WELD	76
AVOID CHANNELLING ON A PVC SOLVENT WELD JOINT	76
WIPE OFF THE EXCESS	77
WHAT TO DO IF IT GOES WRONG	78
<b>INWARD FLOW (HOT TUB) AND OUTWARD FLOW (INTO THE HOT TUB)</b>	79
<b>THE BLOWER</b>	83
<b>HOT TUB WIRING EXPLAINED</b>	85
THE SPA PACK IS THE CENTRAL CONTROL	86
HOT TUB WIRING- THE ELECTRICAL BLOCK	87

CONNECTING THE PUMP	87
CIRCULATION PUMP VS JET PUMP	88
WHAT ABOUT THE PIN OUT DIAGRAMS FOR THE SPA PACK	92
CONNECTING ACCESSORIES LIKE A BLOWER	94
HOT TUB WIRING - CONFIGURING A BALBOA SPA PACK	94
BALBOA DIP SWITCHES EXPLAINED	96
HOT TUB WIRING - CONFIGURING AN ACC SPA PACK	98
VOLTAGE	99
PUMP WIRING	100
UV SYSTEM	102
UV - THE INSTALLATION	103
CHEMICAL FREE OPTION	104
ACTIVE OXYGEN TABLETS	105
CAN I ADD A SALT WATER SYSTEM TO MY HOT TUB	106
<b>ASSEMBLY GUIDANCE</b>	<b>109</b>
FITTING THE GUNITE JETS	111
<b>WHAT ARE GUNITE JET BODIES</b>	<b>116</b>
WHAT DO GUNITE JET BODIES CONSIST OF?	117
HOW DO YOU ASSEMBLE A GUNITE JET BODY	118
ASSEMBLING THE WATER PIPE AND JET HOLDER	120
PIPEWORK	124
FLEXIBLE PIPE TIP	125
THE HOT TUB LIGHT	126
<b>LOCATION CONSIDERATIONS</b>	<b>129</b>
DIMENSIONS	130
INSTALLATION	130
WIRING DIAGRAM	133
CONNECTING THE 12V DC POWER SUPPLY	135

FOREWORD

FOREWORD

FOREWORD

FOREWORD

**FOREWORD**

FOREWORD

FOREWORD

FOREWORD

FOREWORD

# FOREWARD

Building a DIY Hot Tub is such a fun project. I'll be honest, when I built my own hot tub – I didn't have a clue! Looking back, it is an absolute miracle that it worked if I am being totally honest! I made every mistake under the sun!

There were no guides. No plans available just lots of calls to "John the pool man" who I am still friends with today.

Fast forward 7 years and I would like to think today I am an expert in building DIY Hot Tubs. I've helped over 1000 DIYers just like you build their own.

With my plans, parts and guidance, it makes getting the job done a lot easier. The designs are tried and tested as too are the parts and methodology so I know that it will work. Have a good read through this guide – there is a lot of information here that will save you mistakes and money.

Hope you find it useful and don't forget to get in touch for your parts supply too.

Happy Hot Tubbin'

Andi



STRUCTURE  
STRUCTURE  
STRUCTURE  
STRUCTURE  
**STRUCTURE**  
STRUCTURE  
STRUCTURE  
STRUCTURE  
STRUCTURE



The structure will be of one of the options below.

## POURED FORM

Pouring a form is where you are creating a mould out of wood and then filling the mould with concrete to create your walls and seats. This is a popular way of constructing a hot tub. If you do opt for this method, make sure that you brace the walls correctly as the last thing that you want is to have curved walls when you are done!

There is a huge amount of weight and pressure that is created when you pour the concrete so you need a lot of bracing in order for this to work. The end result is a perfectly cast hot tub shape. This is a great way of doing things as you are embedding all your plumbing in advance so fitting the plumbing itself is easier.

You also get a good seal around all of the plumbing components so there are less chances of leaks when you use this method.





# CONCRETE BLOCK CAVITY

One of the challenges of building a DIY Hot Tub or Plunge Pool is getting the correct strength in the walls.

Concrete blocks are arguable the easiest way of building your hot tub. However, if you do a concrete block construction, you are going to want to have a cavity. This cavity will house not only the plumbing, but also the insulation and a rebar construction for added strength.

The downside to this method is that the final construction is quite wide, you can see the measurements below.

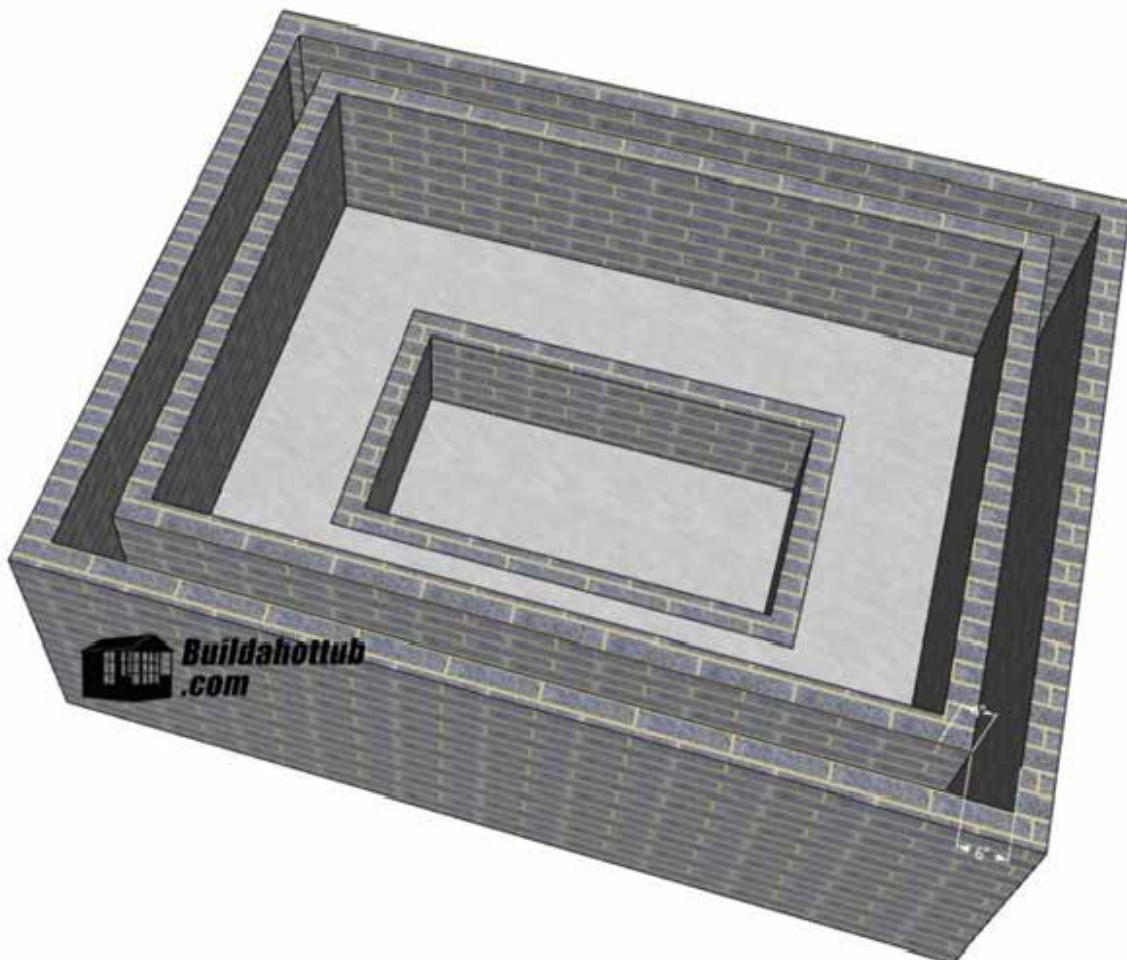

With a 4" block, 6" cavity and then another 4" block, you are at 14" as a minimum. With a cap stone on this, this can look really good. Inside of the cavity you are going to house your plumbing, your insulation and your rebar.

As shown below.

To complete the construction you will then fill the cavity with concrete and make sure it is well vibrated down.

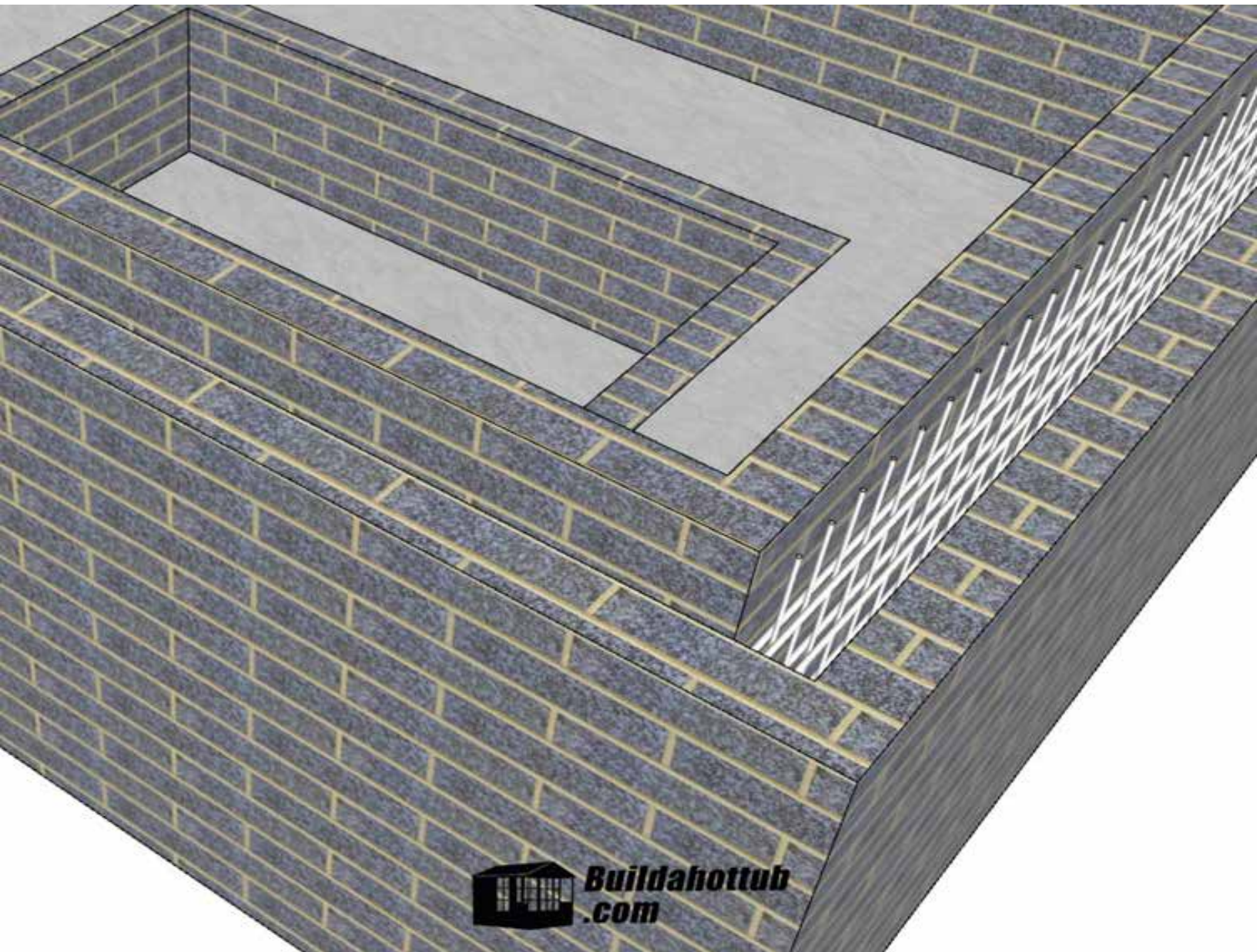



# CMU BLOCK

CMU blocks are the hollow concrete building blocks you commonly see in construction. They are cheap to buy and do a really good job of creating a strong structure for the hot tub.

You can see on the cross section drawing below that the metal rebar ties into the poured concrete base and also the walls too.

You should be rebaring every other hole so that all the blocks are tied into each other.

Once you have finished the structure, then you need to fill with concrete. The diagram also shows horizontal ties – these are optional.

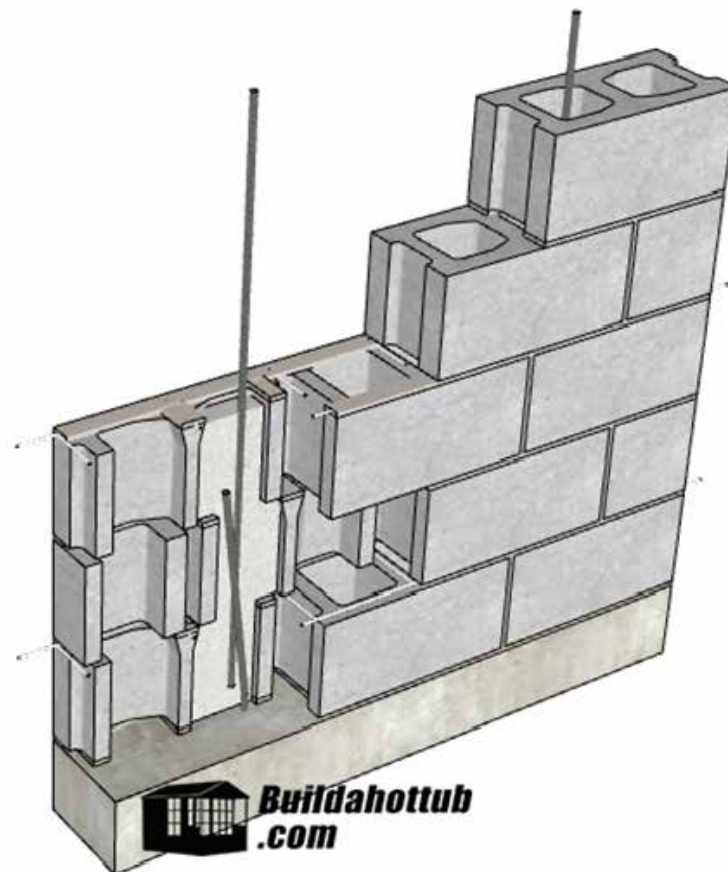

# ICF BLOCK

Insulating concrete form or insulated concrete form (ICF) is a system of formwork for reinforced concrete usually made with a rigid thermal insulation that stays in place as a permanent interior and exterior substrate for walls, floors, and roofs.

The forms are interlocking modular units that are dry-stacked (without mortar) and filled with concrete. The units lock together somewhat like Lego bricks and create a form for the structural walls or floors of a building. ICF construction has become commonplace for both low rise commercial and high performance residential construction as more stringent energy efficiency and natural disaster resistant building codes are adopted. This is a quick and easy way of creating your hot tub or plunge pool. The structure and the strength are already there for you. The main downside is the cost. This is an expensive way of doing things.

